

STATE OF MAINE  
STATE HIGHWAY COMMISSION

PLAN AND PROFILE

**MATTAWAMKEAG RAILROAD CROSSING**  
OVER THE  
CANADIAN PACIFIC RAILWAY  
AND THE  
MAINE CENTRAL RAILROAD  
IN THE TOWN OF  
**MATTAWAMKEAG**  
PENOBSCOT COUNTY  
FEDERAL AID PROJECT NO. FGI-297 (6)

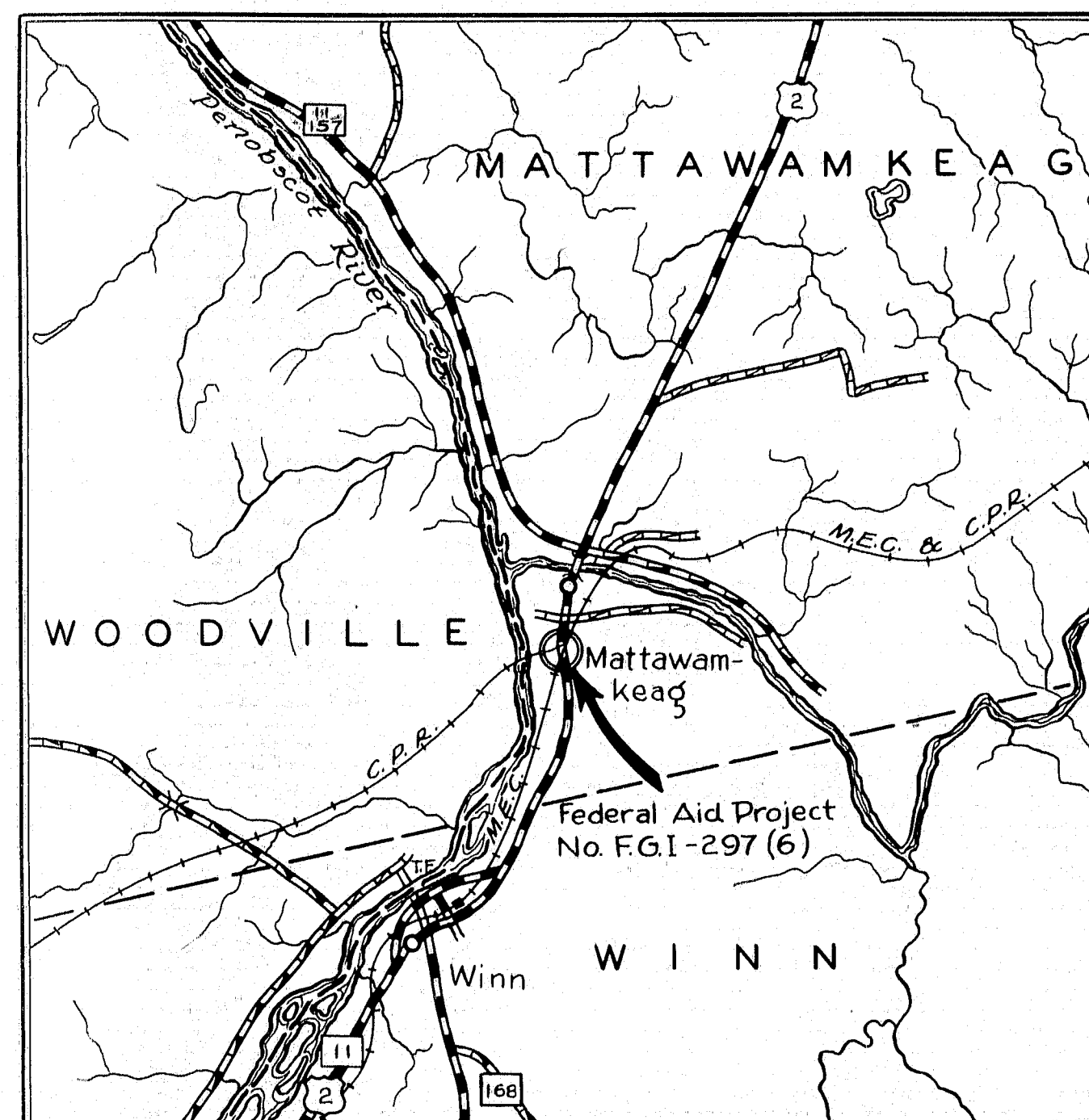

LOCATION MAP  
TRACED FROM S.W.H.P.S.  
APPROX. SCALE 1 INCH = 1 MILE

INDEX OF SHEETS

SHEET NO.	TITLE	PAGE
SHEET NO. 1	SURVEY	
SHEET NO. 2-3	SURVEY	
SHEET NO. 4	SIGNAL DETAILS	
SHEET NO. 5-9	SIGNAL CIRCUITS	

APPROVED:  
MAINE STATE HIGHWAY COMMISSION

*Steward*  
CHAIRMAN  
*George B. Cook*  
*C. J. Russell*  
*William O. Sawyer*  
CHIEF ENGINEER

RECOMMENDED FOR APPROVAL DATE

DISTRICT ENGINEER  
PUBLIC ROADS ADMINISTRATION  
FEDERAL WORKS AGENCY

APPROVED DATE

DIVISION ENGINEER  
PUBLIC ROADS ADMINISTRATION  
FEDERAL WORKS AGENCY



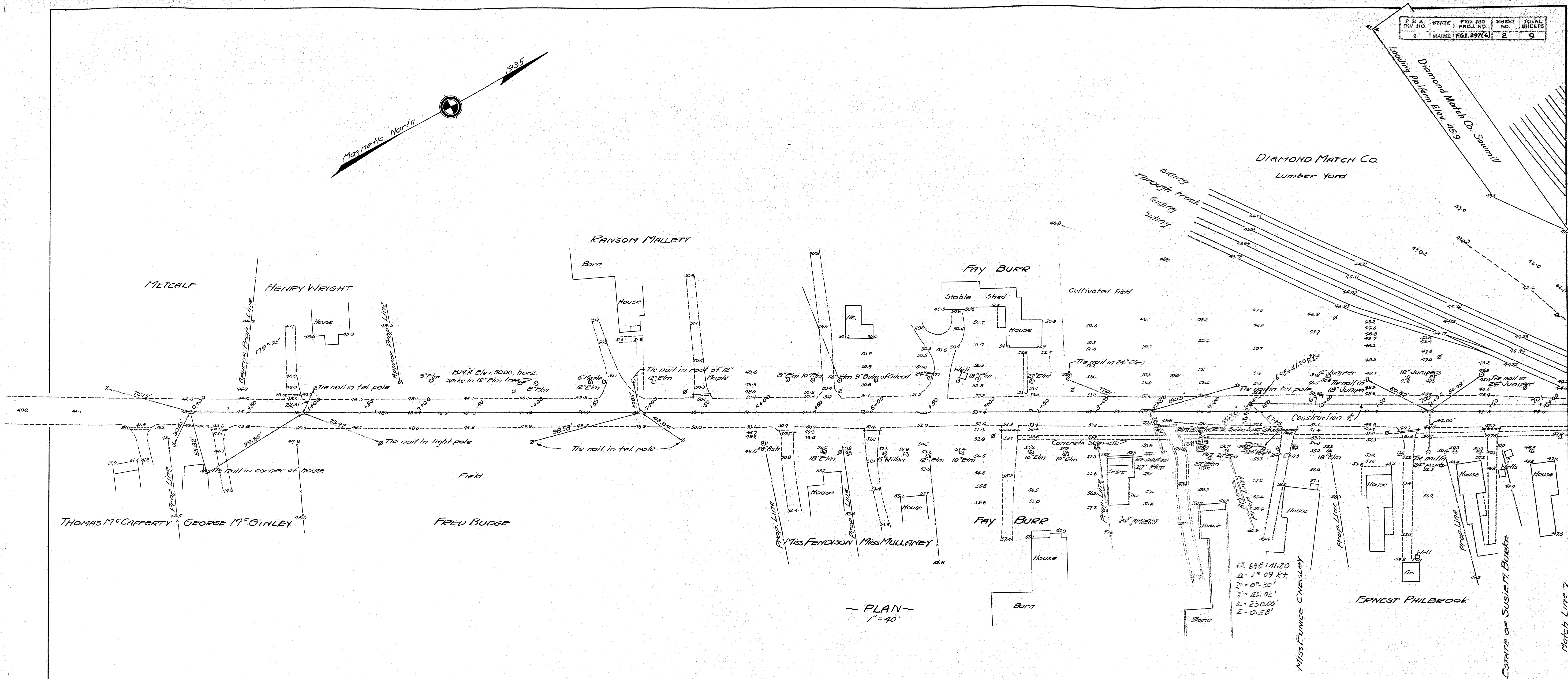
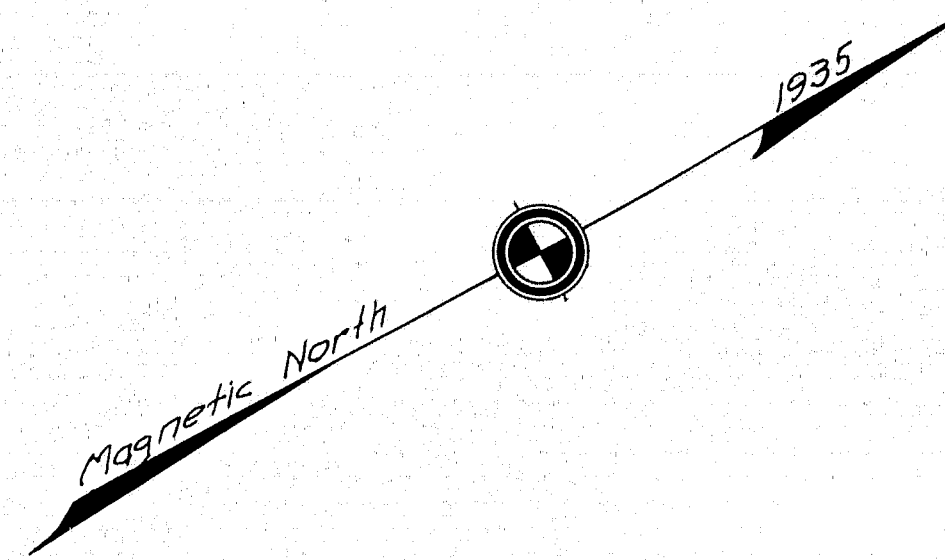

~ PLAN ~  
1" = 40'

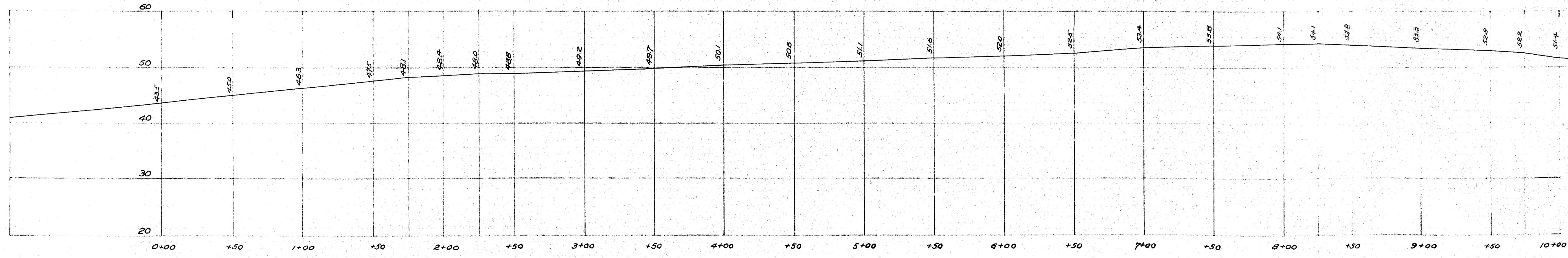

~ PROFILE ~  
Horz. 1" = 40'  
Vert. 1" = 10'

+50 11+00 +50 12+00  
 TOWN 10-44  
 BRIDGE 3235  
 Maine Highway Commission  
 Bridge Division  
 MATTAWAMKEAG RAILROAD CROSSING  
 over  
 CANADIAN PACIFIC RAILWAY  
 and  
 MAINE CENTRAL RAILROAD  
 in the town of  
 MATTAWAMKEAG  
 PENOBSCOT COUNTY  
 SURVEY  
 Sheet 2 of 9 August Me June 1935

Survey by Beckman  
 Plotted by Storgel

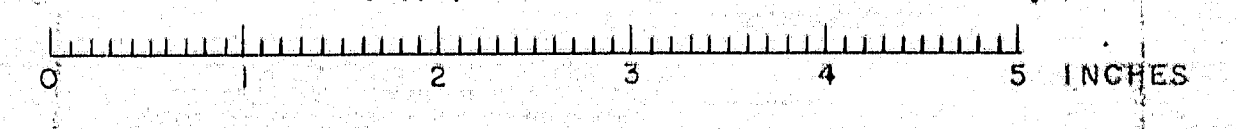







# REFLECTOR BUTTONS

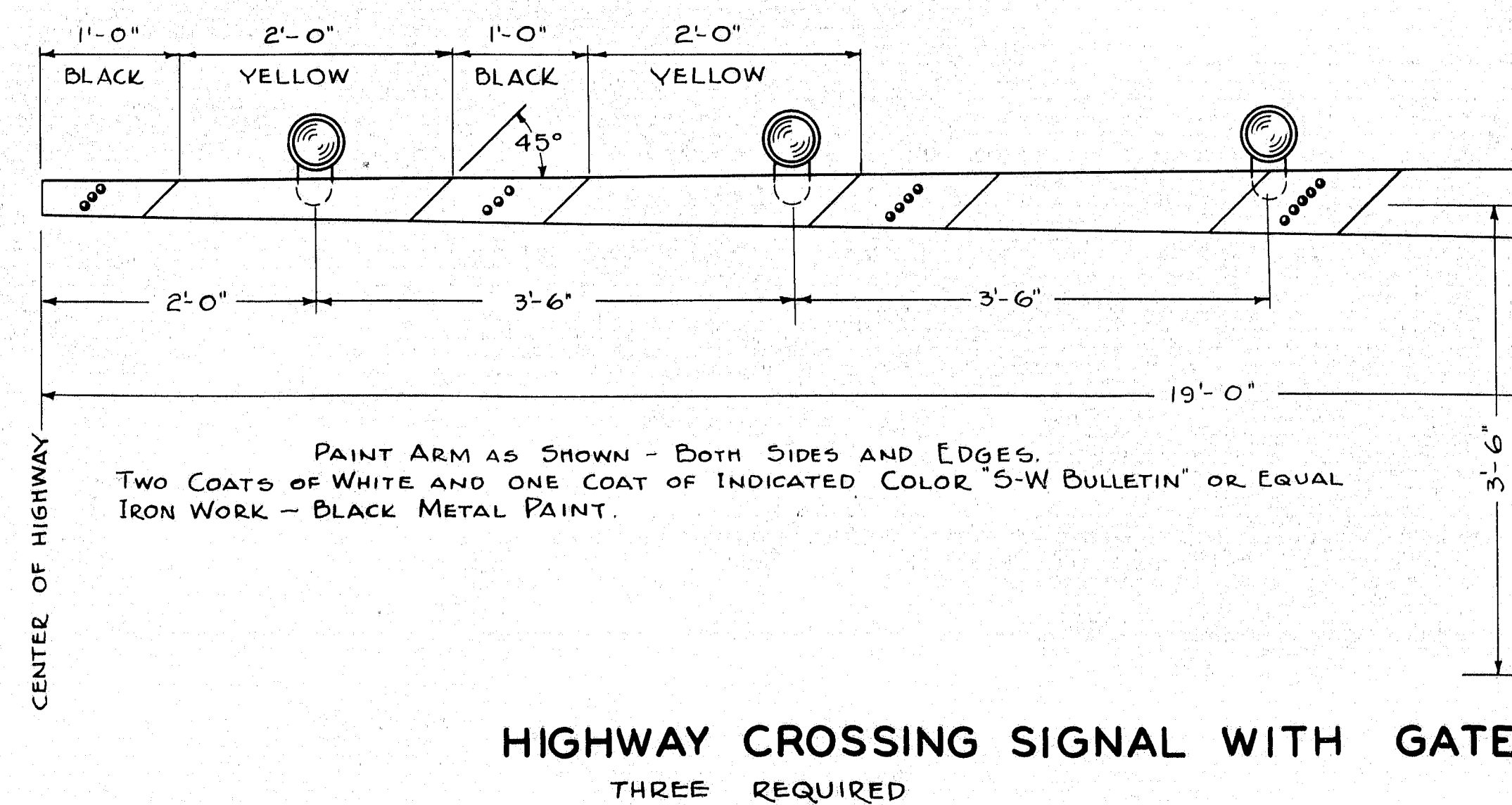
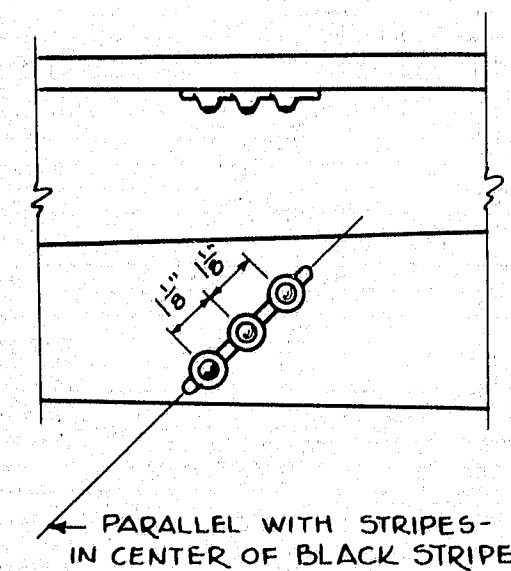

HIGHWAY CROSSING SIGNAL WITH GATE  
THREE REQUIRED

NOTE -  
REFLECTOR SIGN SHALL DISPLAY THE WORDS "STOP ON RED SIGNAL" IN WHITE LETTERS WITH WHITE REFLECTOR LENSES ON BLACK BACKGROUND TOWARD HIGHWAY TRAFFIC APPROACHING THE NEAR SIDE OF THE CROSSING. THIS DRAWING IS TYPICAL AND VARIATIONS IN THE MOUNTINGS ARE PERMISSIBLE. THE NUMBERS REFER TO ASSOCIATION OF AMERICAN RAILROADS, SIGNAL SECTION 1653-C. LAMPS SHALL BE IN ACCORDANCE WITH A.A.R. SPECIFICATION 190.

PAINT ARM AS SHOWN - BOTH SIDES AND EDGES.  
TWO COATS OF WHITE AND ONE COAT OF INDICATED COLOR "S-W BULLETIN" OR EQUAL  
IRON WORK - BLACK METAL PAINT.

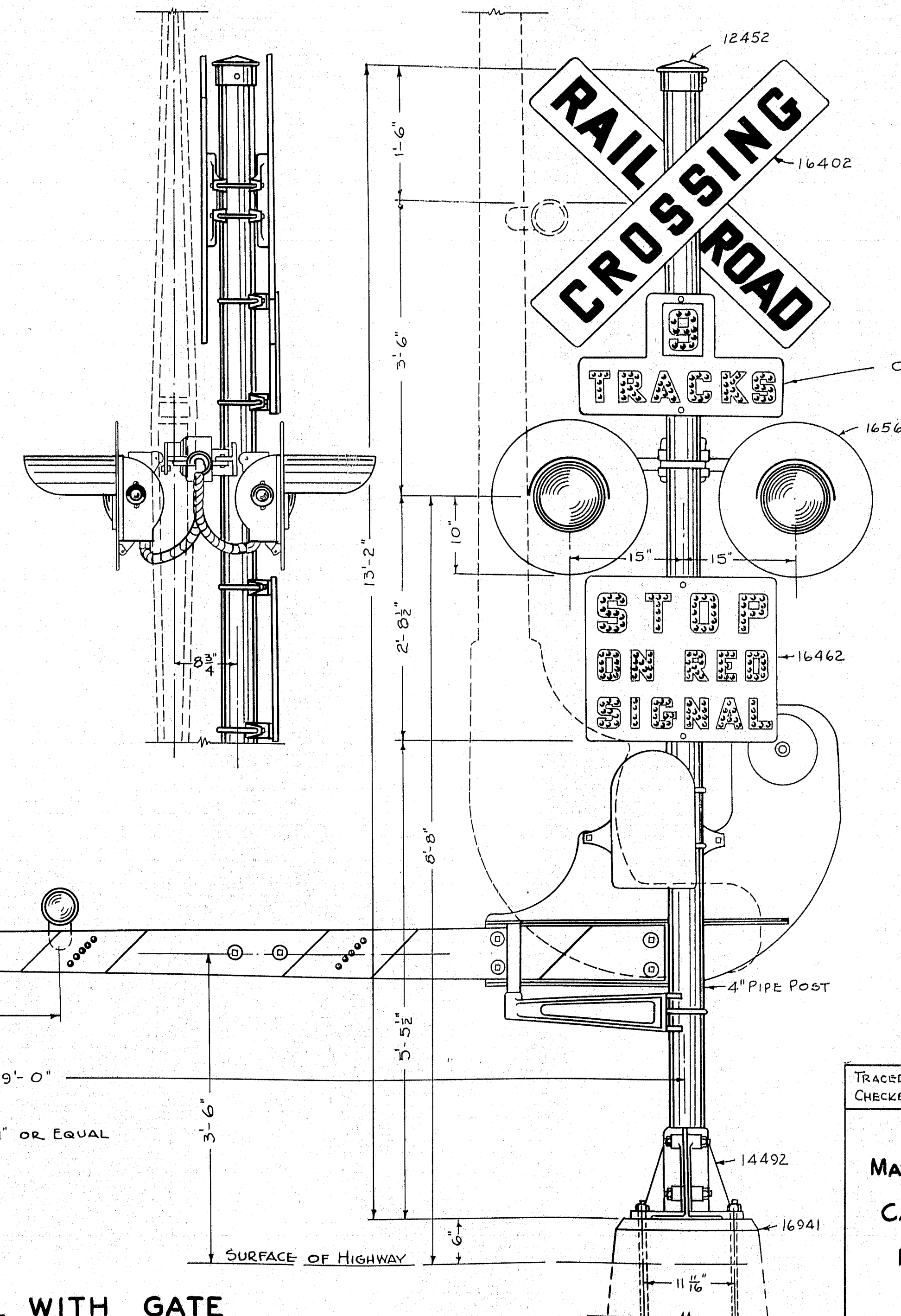

NOTE -  
ONLY TWO "9 TRACKS" SIGNS, 16442, ARE REQUIRED.

TRACED FROM RE. PLANS 123  
CHECKED - R.J.  
State Highway Commission  
Bridge Division  
MATTAWAMKEAG RAILROAD CROSSING  
over  
CANADIAN PACIFIC RAILWAY  
and  
MAINE CENTRAL RAILROAD  
in the town of  
MATTAWAMKEAG  
PENOBSCOT COUNTY  
SIGNAL DETAILS  
Augusta, Me. Oct. 1946  
Sheet 4 of 9







FFM250PAGE1

DESIGNED BY	DRAWN BY	CHECKED BY	DATE	REVISIONS
W. W. WAX	W. W. WAX	W. W. WAX	12-1-45	
W. W. WAX	W. W. WAX	W. W. WAX	12-1-45	
W. W. WAX	W. W. WAX	W. W. WAX	12-1-45	
W. W. WAX	W. W. WAX	W. W. WAX	12-1-45	

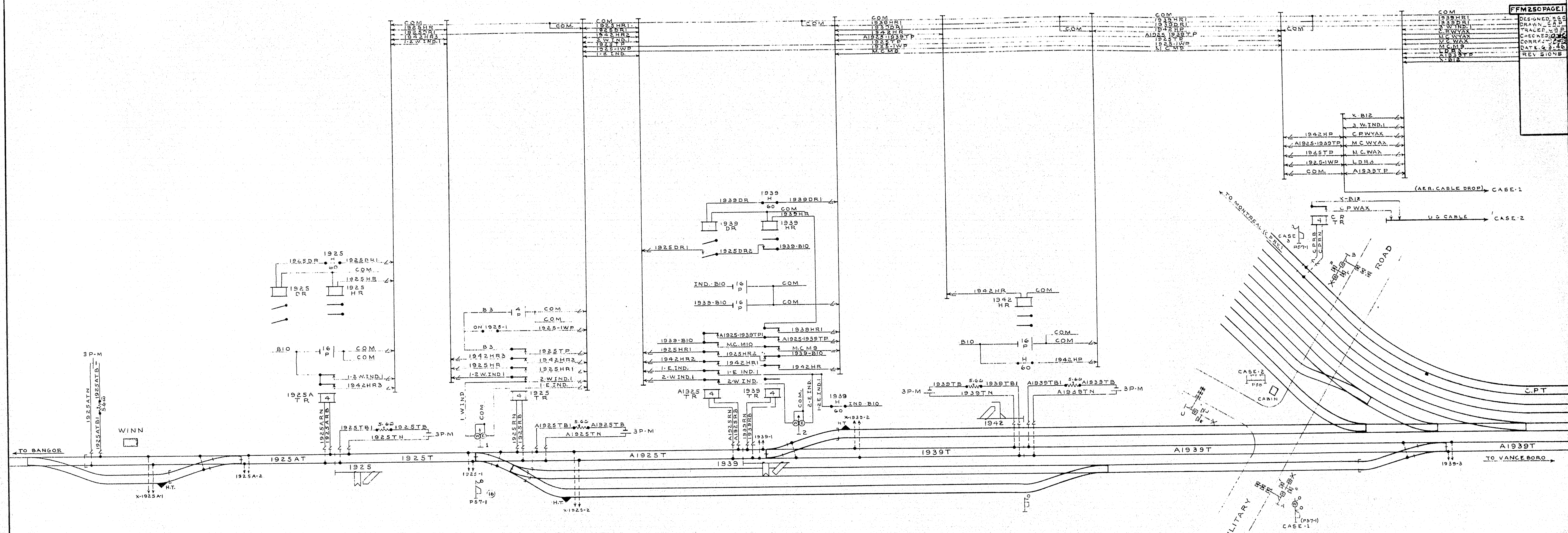

State Highway Commission  
Bridge Division  
**MATTAWAMKEAG RAILROAD CROSSING**  
over  
**CANADIAN PACIFIC RAILWAY**  
and  
**MAINE CENTRAL RAILROAD**  
in the town of  
**MATTAWAMKEAG**  
**PENOBSCOT COUNTY**  
SIGNAL CIRCUITS  
Augusta, Me. Nov. 1946

MAINE CENTRAL R.R. CO. CANADIAN PACIFIC RY. CO.  
EASTERN DIVISION BROWNVILLE DIVISION  
MAIN LINE MATTAWAMKEAG SUBDIVISION  
CIRCUITS FOR HIGHWAY CROSSING PROTECTION  
MILITARY ROAD.  
MATTAWAMKEAG, ME.

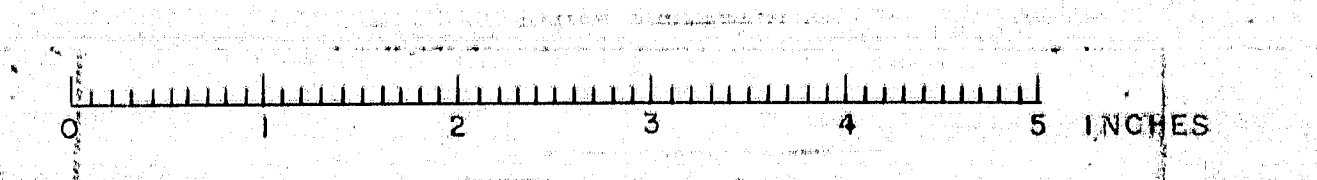







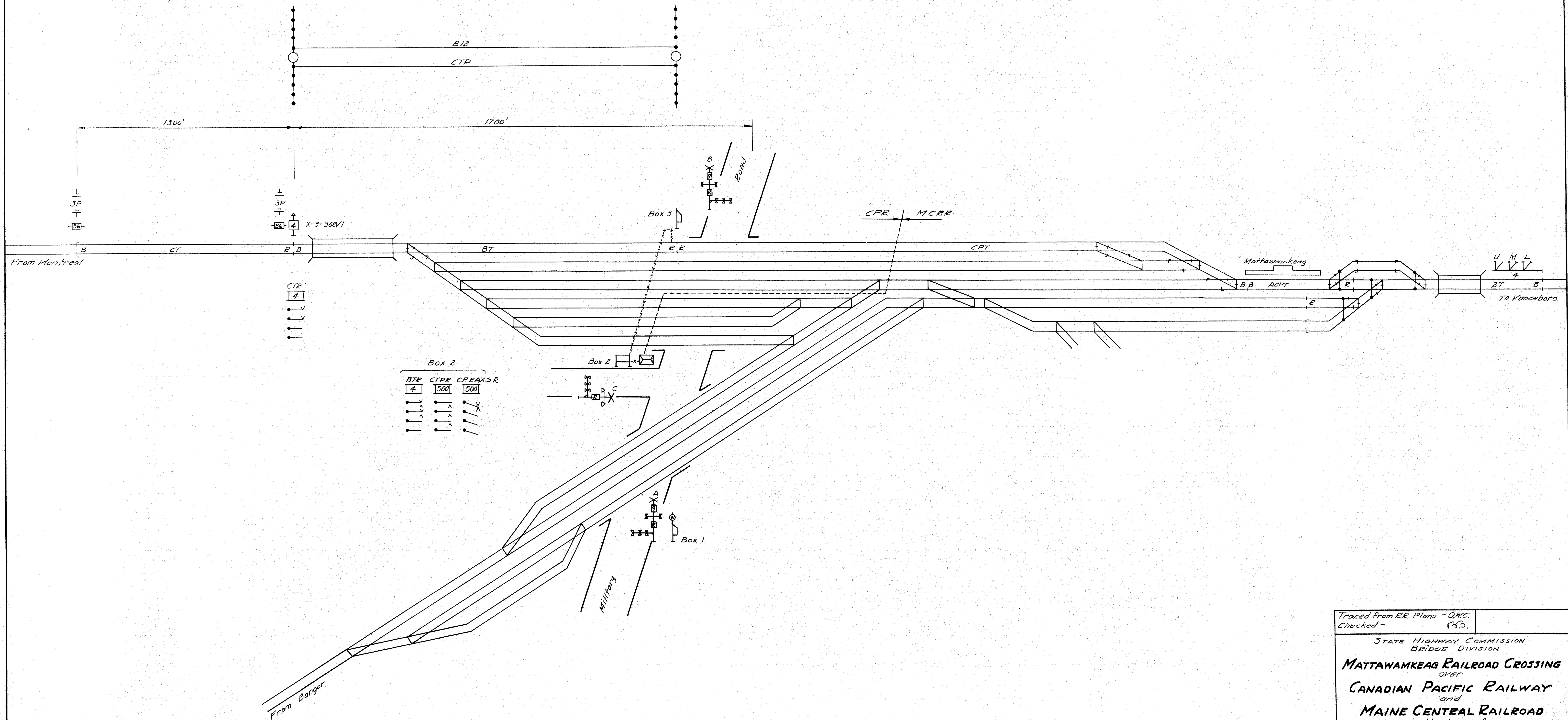

Traced from R.R. Plans - B.W.C.  
Checked - C.B.S.

STATE HIGHWAY COMMISSION  
BRIDGE DIVISION

**MATTAWAMKEAG RAILROAD CROSSING**  
over  
**CANADIAN PACIFIC RAILWAY**  
and  
**MAINE CENTRAL RAILROAD**  
in the Town of  
**MATTAWAMKEAG**  
**PENOBSCOT COUNTY**

SIGNAL CIRCUITS  
Sheet 8 of 9 Augusta, Me. Nov. 1946



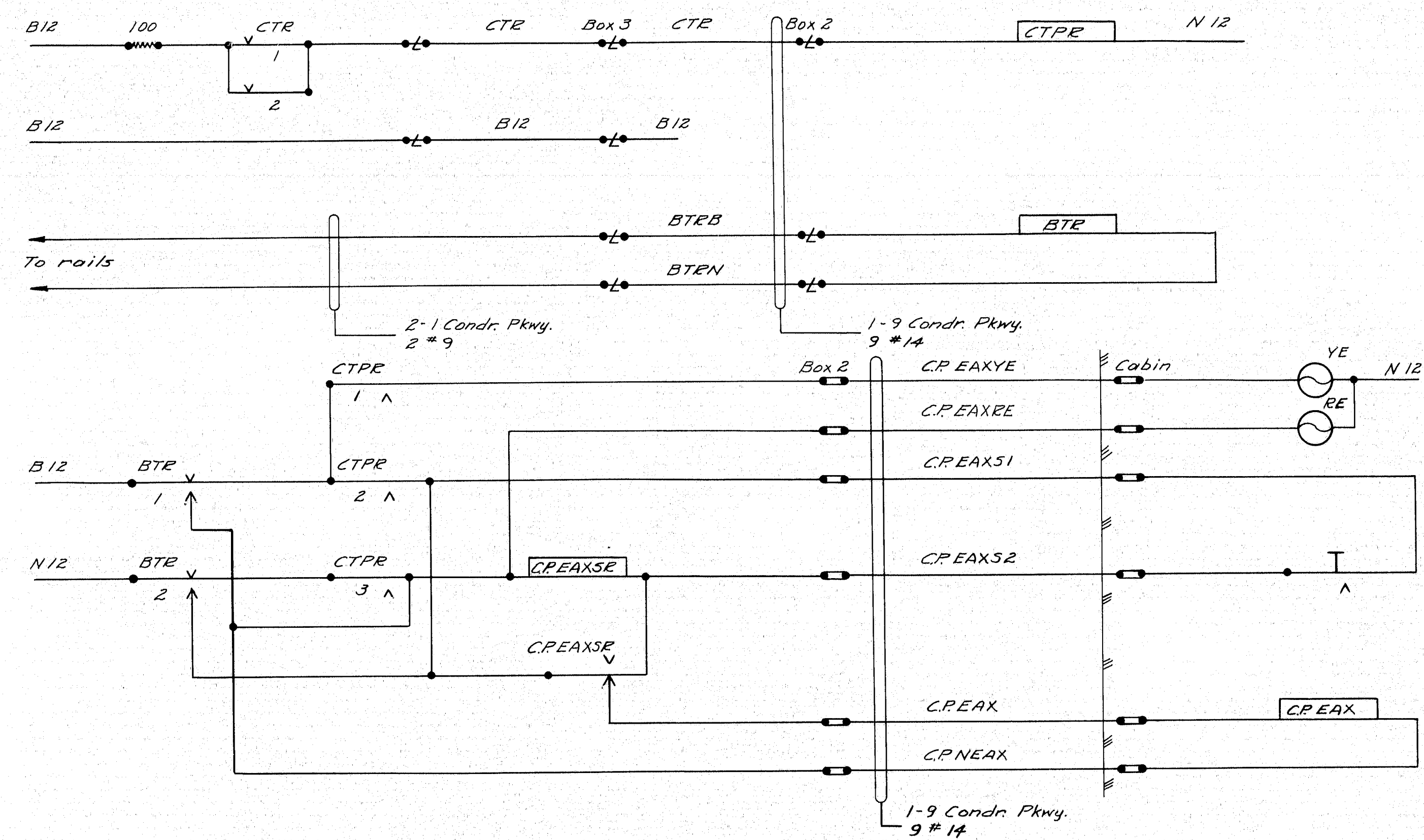

Traced from R.R. Plan - G.W.C.  
 Checked - *(Signature)*

STATE HIGHWAY COMMISSION  
 BRIDGE DIVISION

**MATTAWAMKEAG RAILROAD CROSSING**  
 over  
**CANADIAN PACIFIC RAILWAY**  
 and  
**MAINE CENTRAL RAILROAD**  
 in the town of  
**MATTAWAMKEAG**  
**PENOBSCOT COUNTY**  
 SIGNAL CIRCUITS

Sheet 9 of 9 Augusta, Me. Nov. 1946